

GARDEN HOUSE LOORA-1



Description of the delivery set:

- Basic frame ca 90x70mm (treated)
- Joists ca 70x70mm (treated)
- Floor boards ca 30mm
- Skirting
- Purlins ca 60x160mm
- Roof boards ca 20mm
- Fascia
- Tar paper for roofing
- Windows: tilt-turn opening, double glass, weather stripping, cross bar, battens, unfinished
- Doors: outward opening, 1/2 double glazed, battens, cross bar, cylinder lock and handle, unfinished
- Thread laths for the corners of house
- Nails/screws for mounting the delivery set
- Houses with sleeping platforms have ceiling beams ca 70x145mm, floor boards ca 30mm, battens, ladder

- Terrace is not included – it is possible to buy it separately

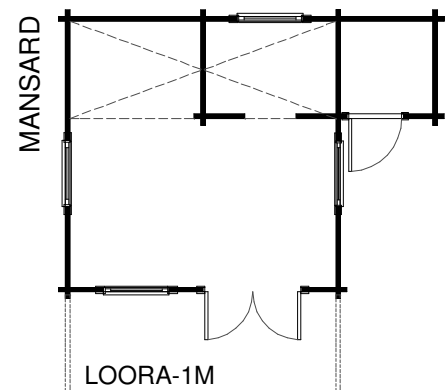
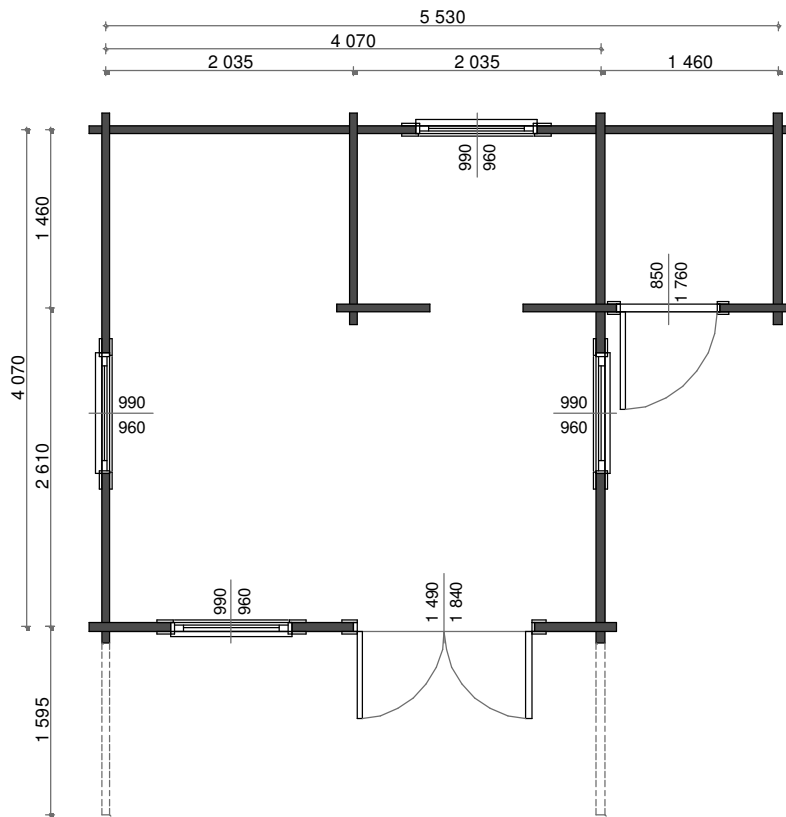

Technical data:	LOORA-1	LOORA-1M
Axis measure of wall:	4070x5530mm	4070x5530mm
Thickness of wall:	70mm	70mm
Height of ridge of a roof:	ca 2850mm	ca 3500mm
Height of side wall:	ca 2150mm	ca 2650mm
Awning:	ca 1595mm	ca 1595mm